

# COMCOUNT

## CH Range of Vibratory Feed Hoppers for Bulk Handling

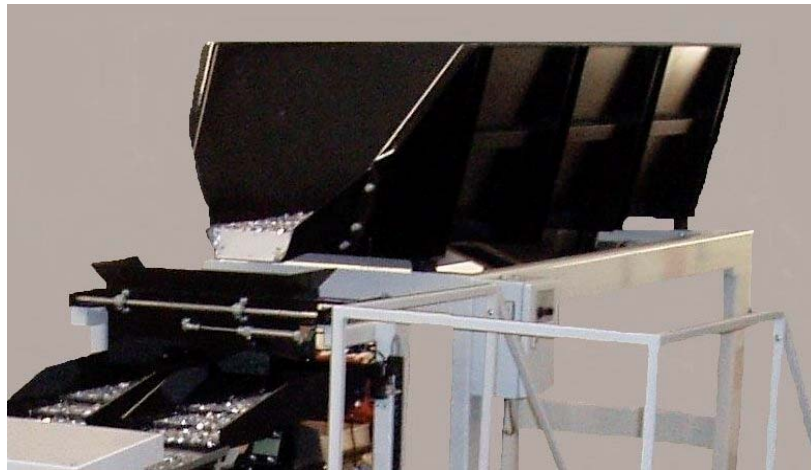

Comcount manufacture a comprehensive range of Vibratory Hoppers designed to hold a bulk quantity of product and feed it on demand into an automatic packaging or production machine.

The units are available in a wide range of sizes with storage capacities ranging from 25 Litres up to 500 Litres and are suitable for handling a wide range of industrial and technical components.

The Smaller 25 and 60 Litre capacity units are particularly suitable for use with the Comcount range of Bowl Feeder Counting and Small Linear Weighing machines.

Stainless Steel versions are available as an option for feeding Pharmaceutical or Medical components.

The Larger 100, 250, 400, and 500 Litre capacity units are ideal for use with the Comcount mid Range and Bulk Weighing Machines.

The units are driven by a powerful electromagnetic vibrator unit and are lined with hardwearing polyurethane coating on the inside faces as standard to reduce noise and product damage.

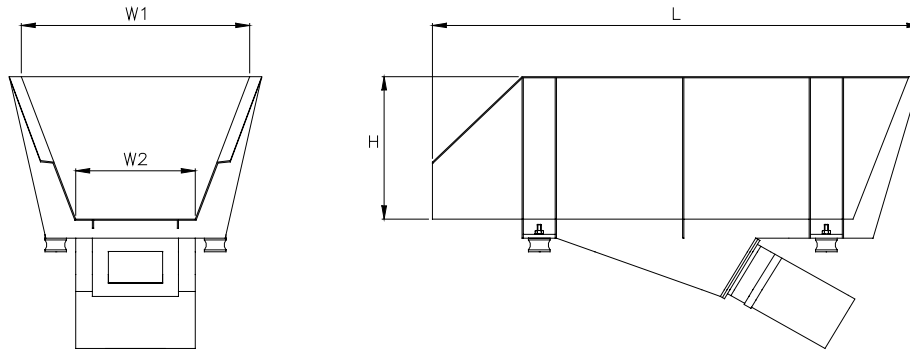

Model	L (mm)	H (mm)	W1 (mm)	W2 (mm)	Volume (Litres)	Capacity (Kg)
CH 25	733	190	347	170	25	25
CH 60	924	300	500	220	60	50
CH 100	1225	375	573	300	100	250
CH 250	1645	472	745	400	250	500
CH 400	2420	472	740	400	400	800
CH 500	2420	472	840	500	500	1000
CH 900	2511	705	1100	600	1330	2000

### Standard Features

Complete Hopper tray vibrates to give most efficient and gentle handling of difficult components.

Hoppers fitted with powerful electromagnetic drive giving large weight capacity with electronic control of feed rate.

Heavy duty Polyurethane coating on contact faces of hopper to reduce noise when running metallic components

FDA approved polyurethane coating or Stainless Steel options to enable handling of food or medical items.

Units mounted on heavy-duty floorstand with adjustable levelling feet.

### Optional Extras

Comcount LT range of Lift and Tip units available to load bulk product into Hoppers mounted at high level.

Comcount SE range of Product Elevators are available to feed product into Weighing Machine in applications where the Hopper is to be mounted at floor level.

## **COMCOUNT**

Unit 16, Shipston Close, Cranham Estate  
 Worcester, WR4 9XN, England  
 Tel: +44 (0)1905 454710  
 Fax: +44 (0)1905 455849  
 e-mail: sales@comcount.co.uk  
 www.comcount.co.uk